



Dear Sunset Ridge Resident,

Melcor Developments Ltd will be starting grading work for the Sunset Ridge Pinnacle. During this construction, we will be hauling fill material to the site. You will notice trucks on your street moving this material. Hauling will take place between the hours of 7 AM - 8 PM, Monday through Saturday, from July 11. This will last for approximately 4 weeks weather permitting. Please see that attached map for the truck route.

Truck drivers will be briefed daily on the 30 KM/h speed limited and the need to inspect tarps and ties before accessing public roadways. Radar speed signs will be in place as per the map for the duration of hauling and street sweepers will clean the streets regularly to ensure the roads remain free of dirt and debris.

Ongoing project updates are available at <https://liveinsunsetridge.ca/construction/>.

If you have any questions or concerns, please contact Ruth Price, Project Coordinator at 403-270-1288 or email [rprice@melcor.ca](mailto:rprice@melcor.ca).

Thank you for your patience as we work to complete this project.

Melcor Development Ltd.

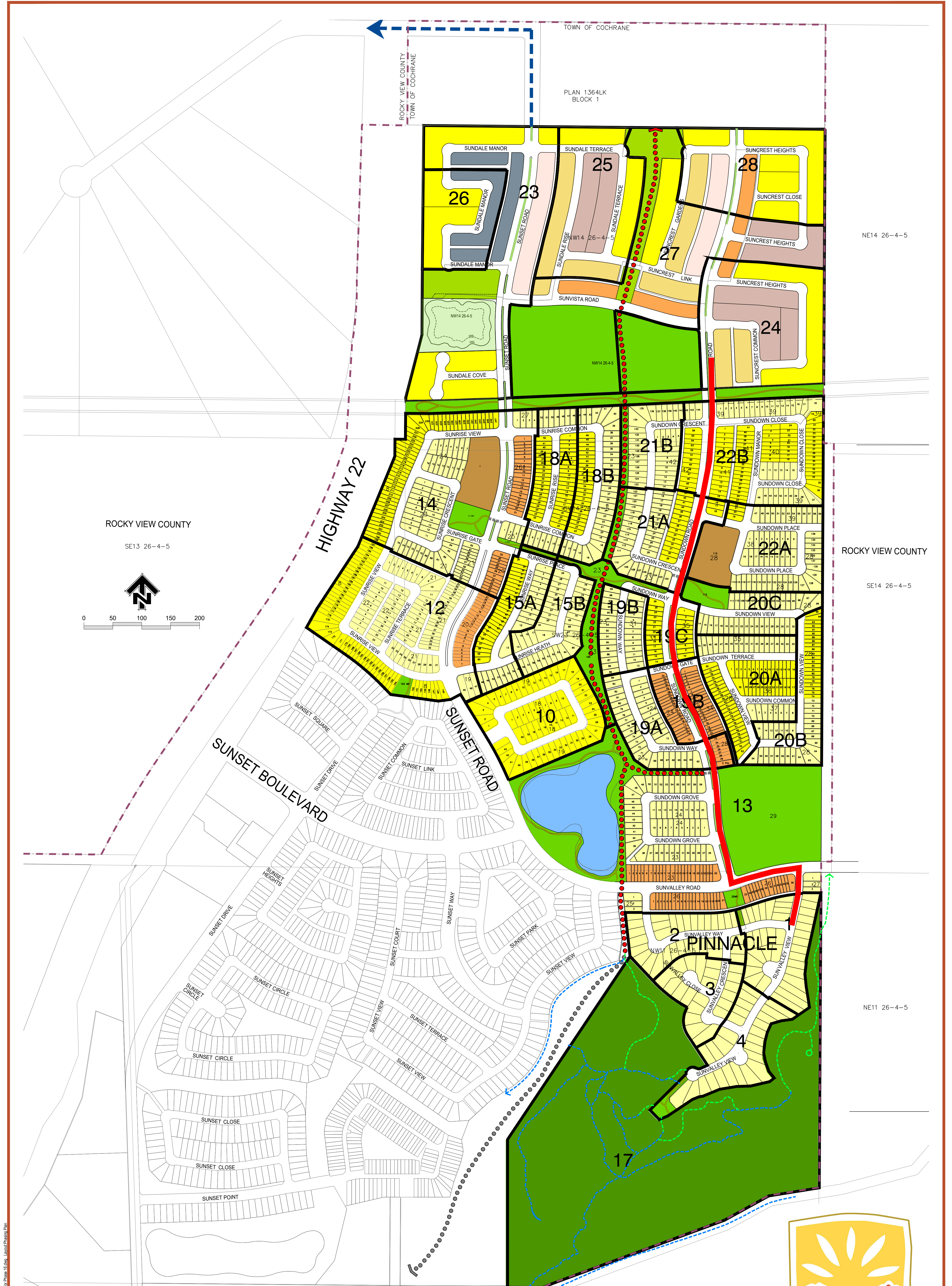

ROCKY VIEW COUNTY  
SE13 26-4-5

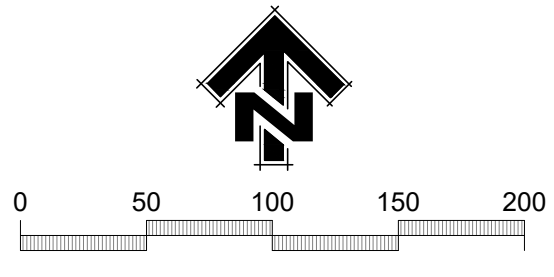

- SINGLE DETACHED DWELLING R-1
- SINGLE AND TWO DWELLING DISTRICT R-2
- SINGLE FAMILY LANELESS R-2 (STAGE 3)
- SINGLE FAMILY LANED R-2 (STAGE 3)
- SINGLE FAMILY SHALLOW-WIDE LANED R-2 (STAGE 3)
- SEMI-DETACHED LANELESS R-2 (STAGE 3)
- SEMI-DETACHED LANED R-2 (STAGE 3)
- MULTI-UNIT DWELLING DISTRICT R-3
- HIGH DENSITY MULTI-DWELLING DISTRICT R-M

- MUNICIPAL RESERVE P-1 (MR)
- ENVIRONMENTAL RESERVE P-1 (ER)
- STORMWATER MANAGEMENT FACILITY P-1 (PUL)
- REGIONAL PATHWAY 3.0m
- LOCAL PATHWAY 2.0m
- REGIONAL PATHWAY BY OTHERS 3.0m
- EXISTING TRAILS TO REMAIN
- NEW TRAILS TO BE CONSTRUCTED/ RECONSTRUCTED



April 2022

Apr 25, 2022 1:28pm W:\22091 Sunset Ridge Stage 3\RD\Drawings\CAD\Plan\1364LK Block 1.dwg for Review 15:00pm J:\Users\jphillips\