

## Plan Notes

### Layout

- ALL CONSTRUCTION SHALL BE IN ACCORDANCE w/ TOWN OF COCHRANE LANDSCAPE SPECIFICATIONS - CURRENT EDITION.
- ALL PATHWAYS, TRAILS AND SEATING AREAS SHALL BE FIELD LOCATED ON-SITE AND APPROVED BY TOWN REPRESENTATIVE PRIOR TO CONSTRUCTION.
- WRITTEN DIMENSIONS SHALL TAKE PRECEDENCE OVER SCALED MEASUREMENTS.
- CONTRACTOR RESPONSIBLE FOR ALL SUBGRADE AND FINISH GRADE INSPECTIONS. A REPRESENTATIVE FROM L.A. WEST SHALL BE PRESENT AT ALL PARKS INSPECTIONS.
- ALL DIMENSIONS ARE IN METERS UNLESS OTHERWISE NOTED.

### Grading

- ENSURE ALL UTILITY INSTALLATIONS HAVE BEEN COMPLETED PRIOR TO ANY EARTHWORK. CONTRACTOR TO ENSURE THE LOCATIONS OF ALL UNDERGROUND UTILITIES ARE MARKED PRIOR TO CONSTRUCTION START CALL BEFORE YOU DIG (1-800-243-3447).
- FOR ALL GRADING CONTRACTOR SHALL FOCUS CONSTRUCTION TO TRAIL ALIGNMENT & MINIMIZE DISTURBANCE TO SURROUNDING ER.
- SUB-GRADE FOR NEW TRAILS TO BE SET +/- 100mm BELOW FINISH GRADE, FOR INSTALLATION OF APPROVED GRANULAR TRAIL MIX.
- SLOPES SHALL NOT EXCEED 3:1 (33.0%) WHEN TYING BACK INTO EXISTING SLOPES.
- WHERE POSSIBLE NEW TRAIL SLOPES SHALL NOT EXCEED 8% & SHALL HAVE MAX. 2% CROSS FALL TO LOW SIDE OF SLOPE.

### Planting

- ALL SEED SHALL BE INSTALLED ON NATIVE TOPSOIL SALVAGED FROM TRAIL STRIPPING & ALIGNMENT - UNLESS OTHERWISE NOTED.
- TOPSOIL TO BE ROCK PICKED & CLEAN PRIOR TO SEED INSTALLATION.
- CONTRACTOR SHALL BE RESPONSIBLE FOR CARE, MAINTENANCE AND ESTABLISHMENT OF SITE THROUGH THE CONSTRUCTION COMPLETION PROCESS. MAINTENANCE OF SITE FROM CONSTRUCTION COMPLETION (CCC) TO FINAL ACCEPTANCE (FAC) SHALL BE THE RESPONSIBILITY OF THE CONTRACTOR.
- CONTRACTOR SHALL NOTIFY L.A. WEST OF ANY DISCREPANCIES BETWEEN PLANT LIST AND DRAWING.

### Limit of Disturbance

DISTURBANCE RESULTING FROM THE NEW TRAIL CONSTRUCTION AND/OR REMOVAL OF EXISTING TRAILS AND ASSOCIATED LANDSCAPING SHALL BE REHABILITATED BACK TO NATURAL STATE AS REQUIRED.

DISTURBANCE SHALL INCLUDE:  
 - CORING / STRIPPING OF NATIVE TOPSOIL  
 - REMOVAL OF EXISTING VEGETATION DUE TO ALIGNMENT OF NEW TRAILS  
 - GRADING & CONTOURING OF SLOPES FROM TRAILS  
 - INSTALLATION OF NEW TRAILS

PROPOSED REHABILITATION & RESTORATION SHALL INCLUDE:  
 - INSTALL EROSION CONTROL SILT FENCE & EROSION CONTROL MEASURES (AS PER ENGINEERING DRAWINGS) TO IDENTIFY LIMITS OF DISTURBANCE. ESC MEASURES SHALL BE INSTALLED ON ESCARPMENT SIDE OF PATHWAY- TO THE SATISFACTION OF THE TOWN INSPECTOR- PRIOR TO CONSTRUCTION  
 - RELOAM ALL DISTURBED AREAS WITH NATIVE TOPSOIL FROM STOCKPILE

ALL DISTURBANCE ZONES ARE TO BE FIELD STAKED TO SHOW LIMIT OF DISTURBANCE PRIOR TO CONSTRUCTION & APPROVED ON-SITE BY TOWN. ONCE APPROVED, THE CONTRACTOR MAY PROCEED WITH THE INSTALLATION OF CONSTRUCTION FENCE & EROSION MEASURES. ENCROACHMENT BEYOND LIMITS OF CONSTRUCTION FENCE WILL NOT BE PERMITTED WITHOUT THE WRITTEN PERMISSION OF PARKS.

LIMIT OF DISTURBANCE SHOWN IS SCHEMATIC ONLY. CONTRACTOR SHALL MAKE EVERY EFFORT TO LIMIT CONSTRUCTION DISTURBANCE TO NEW TRAIL ALIGNMENT. FINAL TRAIL ALIGNMENT TO BE DETERMINED IN THE FIELD & SHALL MAKE EVERY EFFORT TO MINIMIZE DISTURBANCE.

### Construction and Maintenance Program

| CONSTRUCTION   | 2022 |     |      |      |     |     |     |  |  |  |  |  |  |        |
|--|------|-----|------|------|-----|-----|-----|--|--|--|--|--|--|--------|
|  | Apr  | May | June | July | Aug | Sep | Oct |  |  |  |  |  |  |        |
| INSTALLATION OF ESC MEASURES   |      |     |      |      |     |     |     |  |  |  |  |  |  |        |
| STRIPPING & STOCKPILING  |      |     |      |      |     |     |     |  |  |  |  |  |  |        |
| ROUGH GRADING & SHAPING OF TRAILS                                    |      |     |      |      |     |     |     |  |  |  |  |  |  |        |
| INSTALLATION OF GRANULAR TRAIL MIX                                   |      |     |      |      |     |     |     |  |  |  |  |  |  |        |
| INSTALLATION OF LOAM AND GRADE AND REHAB DISTURBED AREAS AS REQUIRED |      |     |      |      |     |     |     |  |  |  |  |  |  |        |
| INSTALL PLANT MATERIAL AND SEEDING                                   |      |     |      |      |     |     |     |  |  |  |  |  |  | C.C.C. |

| MAINTENANCE                        | 2023 |     |      |      |     |     |     |  |  |  |  |  |  |  |
|------------------------------------|------|-----|------|------|-----|-----|-----|--|--|--|--|--|--|--|
|                                    | Apr  | May | June | July | Aug | Sep | Oct |  |  |  |  |  |  |  |
| WEED REMOVAL (MANUAL / MECHANICAL) |      |     |      |      |     |     |     |  |  |  |  |  |  |  |
| SHRUB REPLACEMENT (DISCRETIONARY)  |      |     |      |      |     |     |     |  |  |  |  |  |  |  |
| OVERSEEDING AS REQUIRED            |      |     |      |      |     |     |     |  |  |  |  |  |  |  |

| MAINTENANCE                        | 2024 |     |      |      |     |     |     |  |  |  |  |  |  |        |
|------------------------------------|------|-----|------|------|-----|-----|-----|--|--|--|--|--|--|--------|
|                                    | Apr  | May | June | July | Aug | Sep | Oct |  |  |  |  |  |  |        |
| WEED REMOVAL (MANUAL / MECHANICAL) |      |     |      |      |     |     |     |  |  |  |  |  |  |        |
| SHRUB REPLACEMENT (DISCRETIONARY)  |      |     |      |      |     |     |     |  |  |  |  |  |  |        |
| OVERSEEDING AS REQUIRED            |      |     |      |      |     |     |     |  |  |  |  |  |  | F.A.C. |

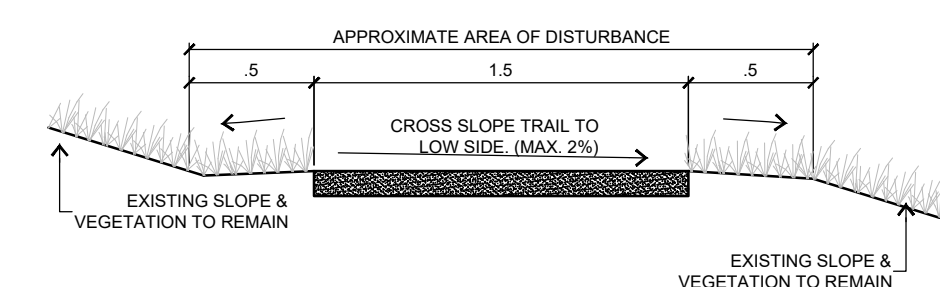

1 Typical Trail Cross Section  
SCALE - 1 : 30

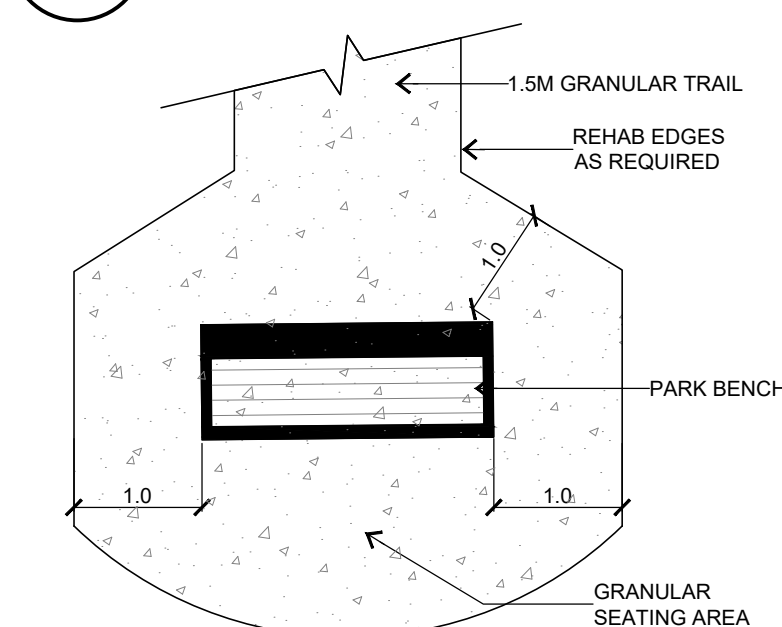

2 Trail View Point  
SCALE - 1 : 50

## Plan Legend

- EXISTING CONTOURS
- EXISTING TRAILS TO REMAIN
- EXISTING TRAILS TO BE REMOVED
- NEW TRAILS TO BE CONSTRUCTED/ RECONSTRUCTED
- EXISTING TREE STAND
- TRAIL VIEWPOINT / SEATING AREA C/W SURFACE MOUNT ON CONCRETE SLAB. REFER TO ZL1.
- MINOR GRADING - PROPOSED NEW CONTOURS, TYPICAL
- LIMIT OF DISTURBANCE DUE TO GRADING - REHAB AS REQUIRED. REFER TO PLAN NOTES.
- PROPOSED NEW 3.0m PAVED PATHWAY.
- PROPOSED 1.5m WIDE GRANULAR TRAILS / SEATING AREA, TYP.

## Seed Application & Establishment & Maintenance

- CONTRACTOR SHALL SUPPLY SEED CERTIFICATES TO TOWN INSPECTOR @ PREP INSPECTION PRIOR TO SEED APPLICATION. ANY SUBSTITUTIONS SHALL BE SUBJECT TO TOWN APPROVAL
- ALL DISTURBED AREA SHALL BE HAND SEEDING ON A MINIMUM 150mm DEPTH OF NATIVE TOPSOIL (SUPPLIED FROM STRIPPING OF TRAIL)- UNLESS OTHERWISE NOTED.
- TOPSOIL TO BE ROCK PICKED & CLEANED PRIOR TO SEED INSTALLATION - CONTRACTOR SHALL OBTAIN ALL REQUIRED FINISH PREP INSPECTIONS PRIOR TO SEEDING - ENSURE NATIVE TOPSOIL IS FREE OF BROOME GRASS & INVASIVE WEEDS.
- TRACK PACKING IS REQUIRED FOR TOPSOIL PREPARATION ON ALL SLOPES GREATER THAN 33%. UPON SITE INSPECTION & INSTRUCTION, EROSION CONTROL MATTING MAY BE REQUIRED ON SLOPES THAT EXCEED 33%.
- CONTRACTOR TO PERFORM BIWEEKLY INFECTIOUS WEED INSPECTIONS & MONITORING - CHECK FOR CANADA THISTLE, SMOOTH BROMEGRASS & ADDRESS AS REQUIRED.
- INFECTIOUS WEED EMERGENCE DURING GROWING SEASON TO BE ADDRESSED w/ LOCALIZED MANUAL WEED REMOVAL & SPOT APPLICATIONS OF NON-SELECTIVE HERBICIDES.
- SHOULD WEED GROWTH PERSIST - BROAD SCALE SPRING (PRE SEED) APPLICATION OF SELECTIVE HERBICIDES (TRANSLINE) WILL BE REQUIRED.
- MOWING OF SEEDED AREAS LIMITED TO FIRECRACKS ONLY. (IF ANY)

## Seed Mixture

- HAND SEED WITH UPLAND NATIVE SEED MIX - NON-IRRIGATED REHAB MIX
- AGGRESSIVE NATIVE GRASSLAND MIX - APPLIED BY HAND AS REQUIRED.
- 25% ROCKY MOUNTAIN FESCUE
- 20% SLENDER WHEATGRASS
- 20% GREEN NEEDLE GRASS
- 15% FOWL BLUEGRASS
- 10% JUNE GRASS
- 10% BLUE FLAX

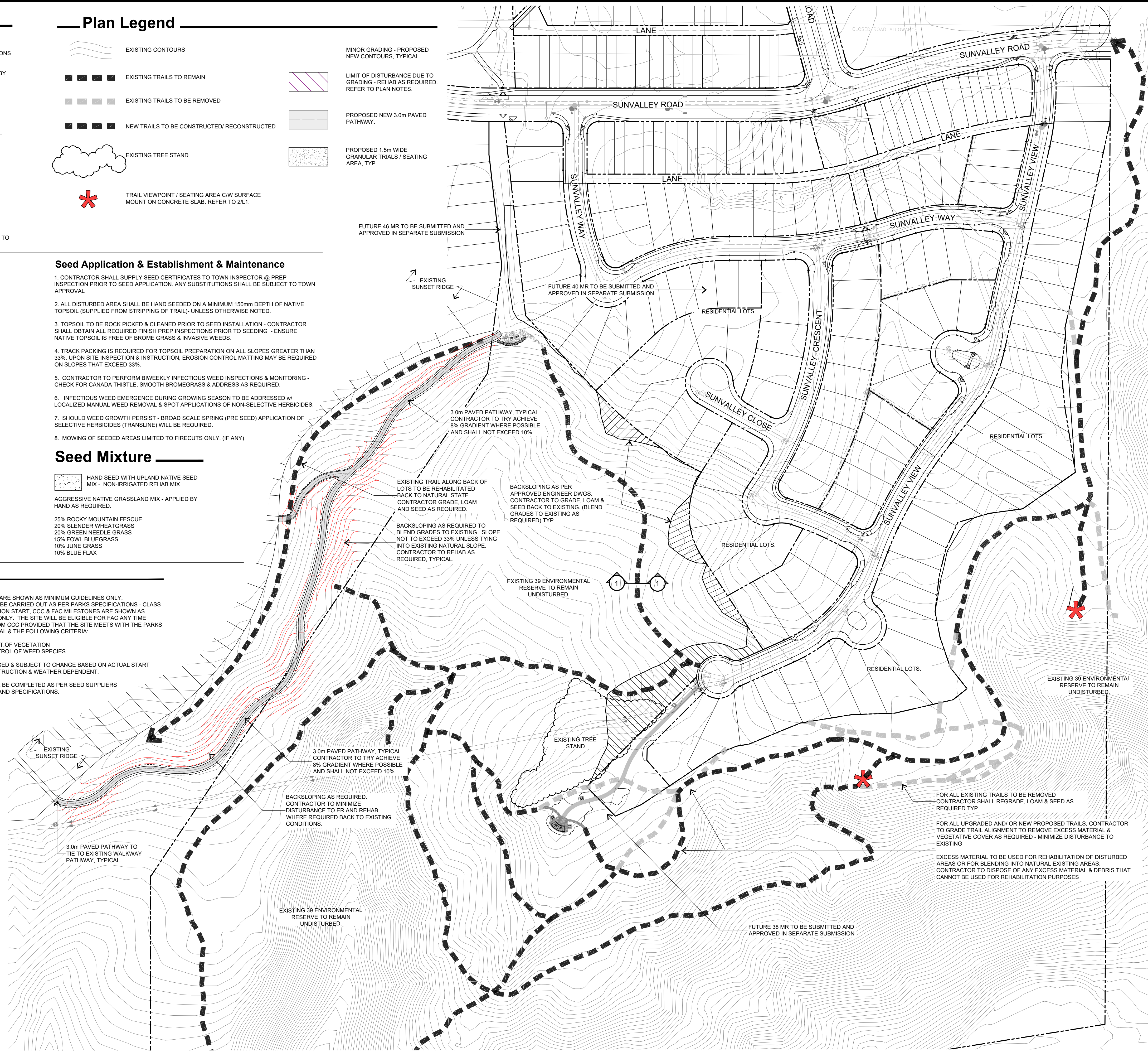

# L.A. West

(Calgary) Inc.  
 Landscape • Architectural • Design • T2M 2P5  
 Off: (403) 233-0921 Fax: (403) 233-0927

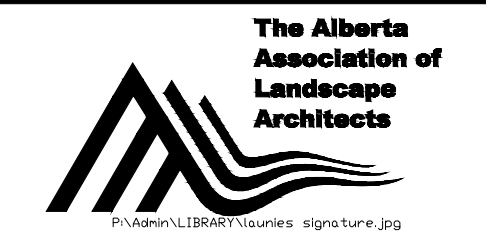

Launie J. Burrows

| no. | date     | description                   |
|-----|----------|-------------------------------|
| D   | 08/08/22 | RESUBMIT TO TOWN FOR APPROVAL |
| C   | 07/26/22 | RE-GRADE TO REDUCE FILL       |
| B   | 07/17/22 | GRADING FOR PAVED PATHWAY     |
| A   | 06/20/22 | PARKS SUBMISSION              |

## SUNSET PROPERTIES

client  
 project  
 THE PINNACLE

## RESTORATION PLAN

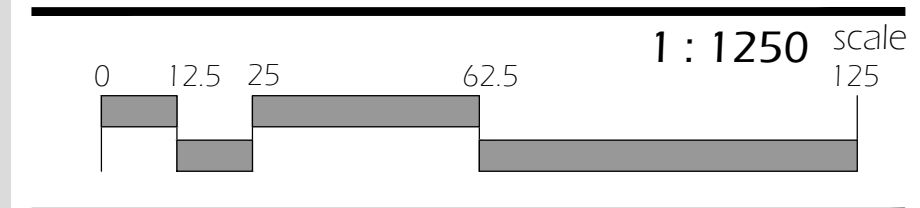

|          |                 |
|----------|-----------------|
| drawn    | project no.     |
| CRB      | LAW.080.013.044 |
| design   | sheet no.       |
| SGW      | L1              |
| date     |                 |
| 01.26.22 |                 |